

2. Inner wiring

2.1 Harness wiring inside the manipulator

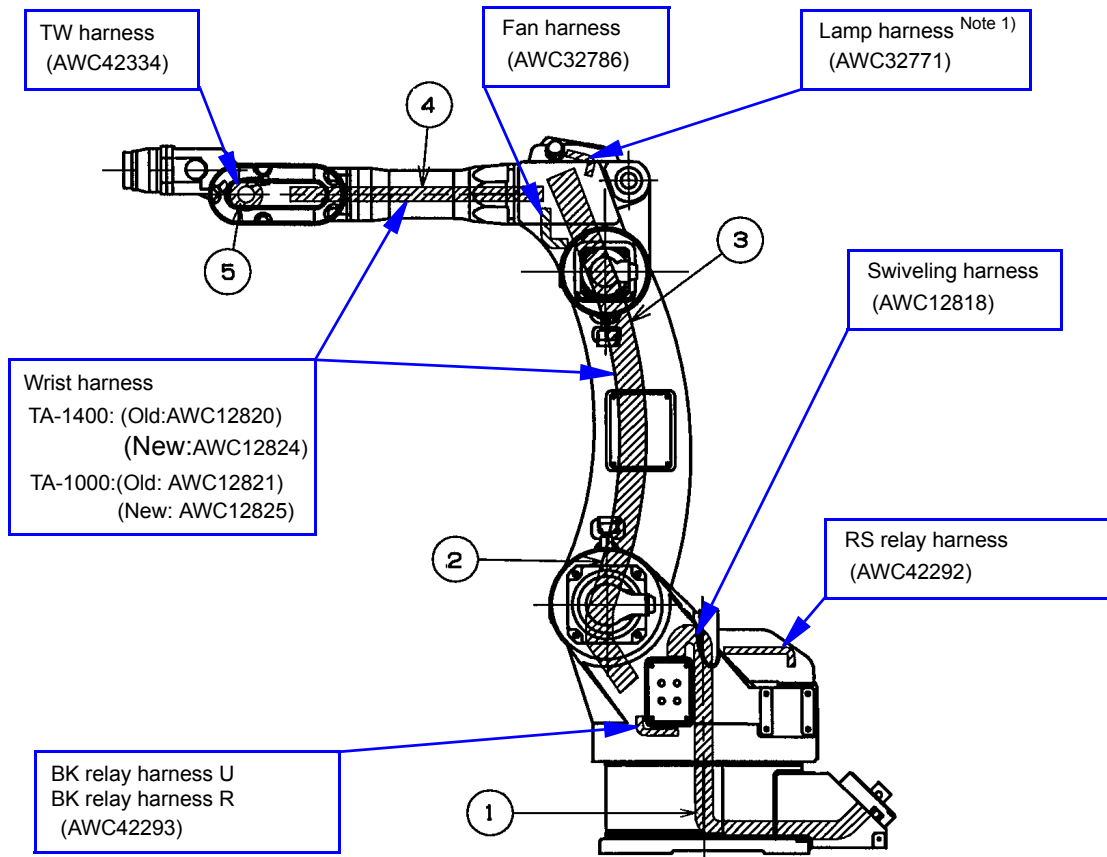

Note 1) Only R and U types manipulators can use the servo ON indication lamp.
As for T, Y and E types manipulator, this function is optional. (Separately sold).

Grease application quantity			
<Grease application is required for the following parts whenever you replace harness.>			
1	RT axis rotation part	5 g	Albania No.2
2	UA axis rotation part	Not required	-
3	FA axis rotation part	Not required	-
4	RW axis rotation part	5 g	Albania No.2
5	BW axis rotation part	1 g	Albania No.2